

10 Lincoln Square

Gettysburg, PA | 17325

For Lease



Property Overview

Storefront on the square of Gettysburg. 10 Lincoln Square is 3,800 square feet with 40' of window frontage. This first floor space has 10' ceilings, gas FHA, CAC, and two restrooms. A portion of the area has tin ceilings. Directly in front of the space are eight metered parking spaces. There is a rear loading door and two, dedicated off-street parking spaces. Neighboring uses include retail, hospitality, residential, performing arts, and office. The lease rate is \$20/SF.

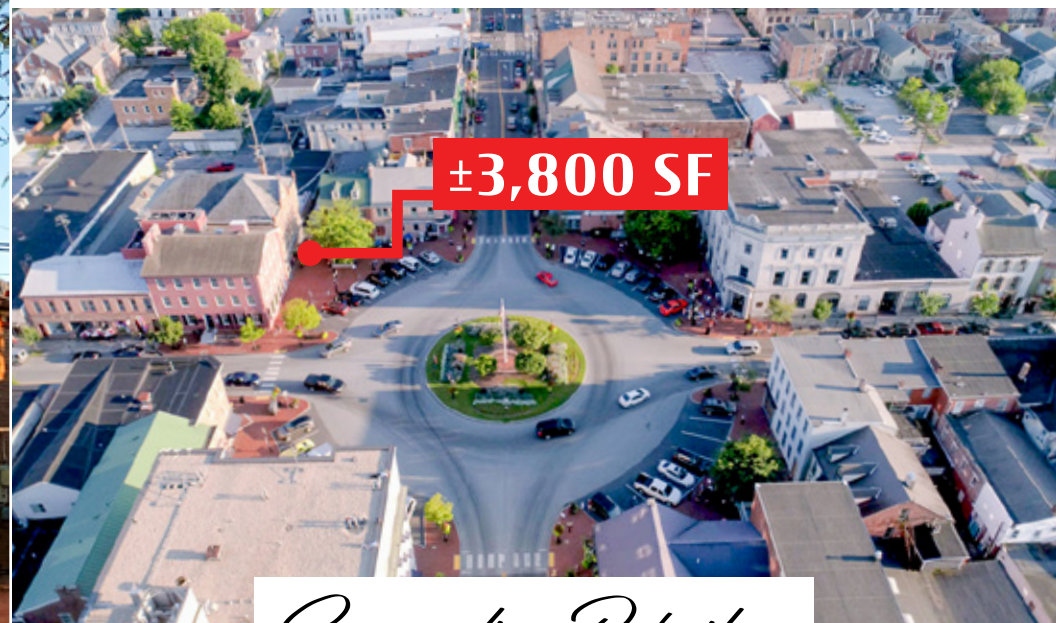

Surrounding Retailers



the Upper Crust



GALLERY 3D

WALDO'S & COMPANY



Ryan Myers

For Leasing Information: 717.843.5555 | Learn more online at www.bennettwilliams.com



COMMERCIAL BROKERAGE. *Redefined*

10 Lincoln Square

Gettysburg, PA | 17325

For Lease

Location

The property is located directly on the square in Gettysburg. The history of the Battle of Gettysburg draws over 1,000,000 tourists to this town annually. Gettysburg is the county seat for Adams County. It is located approximately 15 minute drive time from the Pennsylvania/Maryland border. Gettysburg College is located four blocks north of the square.

Gettysburg Tourism



1 MILLION+
TOURISTS A YEAR



8,000+
TOURISM INDUSTRY JOBS



\$691 MILLION
SPENT ON TOURISM VISITS



DEMOGRAPHICS	1 MILE	3 MILE	5 MILE
TOTAL POPULATION	7,459	15,312	23,288
TOTAL EMPLOYEES	6,801	10,532	12,547
AVERAGE HHI	\$72,512	\$85,587	\$84,395
TOTAL HOUSEHOLDS	2,457	5,707	8,698

TRAFFIC COUNTS: **Lincoln Hwy** ± 20,000 VPD



Ryan Myers

For Leasing Information: 717.843.5555 | Learn more online at www.bennettwilliams.com



COMMERCIAL BROKERAGE. *Redefined*

10 Lincoln Square

Gettysburg, PA | 17325

For Lease

FLOOR PLAN

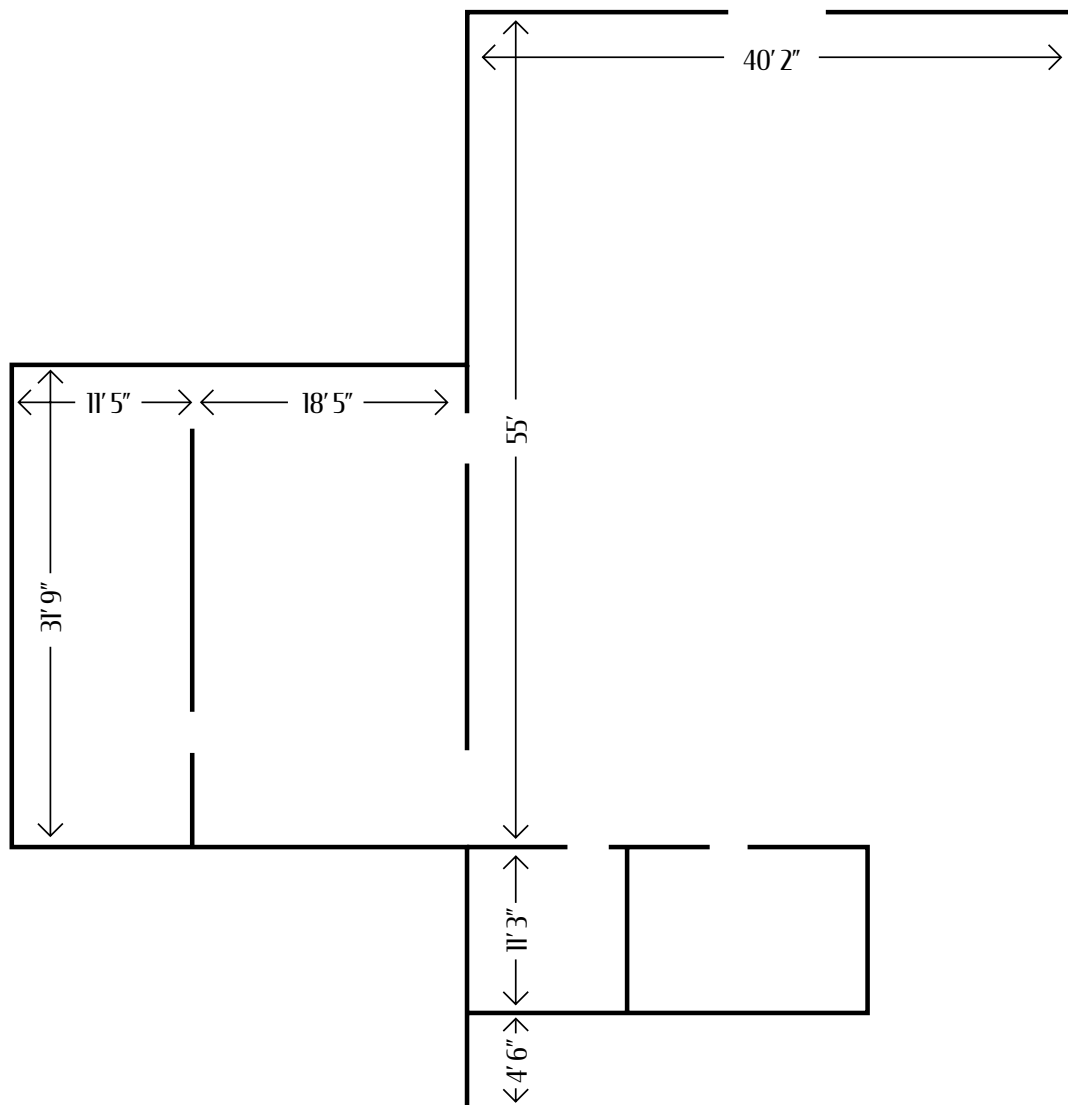

GROUND FLOOR RETAILSPACE

±3,800 SF Available for Lease



Ryan Myers

For Leasing Information: 717.843.5555 | Learn more online at www.bennettwilliams.com

ACTIVE MEMBER OF:
RETAIL BROKERS
NETWORK

COMMERCIAL BROKERAGE. *Redefined*

10 Lincoln Square

Gettysburg, PA | 17325

For Lease

GETTYSBURG SQUARE



Ryan Myers

For Leasing Information: 717.843.5555 | Learn more online at www.bennettwilliams.com

ACTIVE MEMBER OF:
RETAIL BROKERS NETWORK

COMMERCIAL BROKERAGE. *Redefined*

10 Lincoln Square

Gettysburg, PA | 17325

For Lease

MARKET AERIAL



Ryan Myers

For Leasing Information: 717.843.5555 | Learn more online at www.bennettwilliams.com

ACTIVE MEMBER OF:
RETAIL BROKERS NETWORK

COMMERCIAL BROKERAGE. *Redefined*

About Bennett Williams



Since its founding in 1956, Bennett Williams Commercial, Inc. has offered full Commercial Real Estate services to the Central Pennsylvania region and beyond. We have served thousands of commercial, industrial and retail clients as we have grown in size and reputation. With our team of both experienced and knowledgeable executives as well as young and energetic professionals, we have the team to handle any commercial real estate need.

At Bennett Williams, your investments are always in good hands. Our retail Investment sales group provides top notch investment sales services for all categories of retail investments for both buyers and sellers alike, whether institutional or local, throughout the Central Pennsylvania landscape. Whether the asset is a single or multi-tenant, we pride ourselves in going above and beyond the expectations of the client to achieve maximum results. With over 60 years under our belt, and over 25 licensed real estate professionals, we possess the knowledge, experience, and dedication trusted by many in the investment sales segment of the industry.



Bennett Williams is a member of the Capital Markets Real Estate Network, a nationwide network of professionals dedicated to, and specializing in the capital markets segment of commercial real estate. CMRE is comprised of the most highly-qualified, best-experienced independent Capital Market real estate professionals.

INVESTMENT ADVISORS:

Ryan Myers

rmyers@bennettwilliams.com

OUR LOCATIONS:

YORK OFFICE:

3528 Concord Rd.
York, PA 17402

EXTON OFFICE:

1 E. Uwchlan Ave.
Suite 409, Exton, PA 19341

CONTACT US

717.843.5555
www.bennettwilliams.com

LANCASTER OFFICE:

2173 Embassy Dr., Suite 201
Lancaster, PA 17601

NEW JERSEY OFFICE:

309 Fellowship Rd, Suite 200
Mt. Laurel, NJ 08054

