

# Stony Battery Corporate Center: Lot 6

Lancaster, PA 17601

Available For Sale

## Property Overview

9.32 acres in Stony Battery Corporate Center available for sale or build-to-suit-to-lease. Light Industrial zoning. Easy access to Route 283, Route 30, and PA 23. Near Saadia Distribution Center, Shyft Group, Americold, Terex, and many other industrial users.

## Highlights

- 9.32 acres zoned I-1 Light Industrial
- Available for sale or build to suit to lease (lease rate determined by tenant's needs)
- Common stormwater management system in place
- Easy access to Route 283, Route 30, and PA 23
- Near Saadia Distribution Center, recently constructed distribution centers on Stony Battery Road, and many other industrial users
- Seller maintains right to be exclusive builder for project

## Prices

**LOT 6** - 9.32 AC - \$2,376,000  
\$250,000/AC



Jeff Herr | Jeffrey Herr

For Leasing Information: 717.843.5555 | Learn more online at [www.bennettwilliams.com](http://www.bennettwilliams.com)



COMMERCIAL BROKERAGE. *Redefined.*



# Stony Battery Corporate Center: 6

## Corporate Blvd And Marietta Ave, Lancaster, PA 17601

Available For Sale

Note: This map, table 1, and calculations will be updated upon final land development plan approvals for the remaining vacant sites in Stony Battery Corporate Center

**TABLE 1**  
Calculations for maximum Gross Floor area of Accessory Use Buildings provided for in the Business Overlay District

Parcel Address	Lot #	Existing Non-Accessory Use Gross Floor Area	Existing Accessory Use Gross Floor Area
Corporate Blvd	1-4	0 ft <sup>2</sup>	0 ft <sup>2</sup>
725 Indian Springs Dr	5	0 ft <sup>2</sup>	0 ft <sup>2</sup>
Indian Springs Dr	6,7	0 ft <sup>2</sup>	0 ft <sup>2</sup>
760 Indian Springs Dr	9	0 ft <sup>2</sup>	0 ft <sup>2</sup>
Indian Springs Dr	10	0 ft <sup>2</sup>	0 ft <sup>2</sup>
700 Indian Springs Dr	11-16	376,584 ft <sup>2</sup>	0 ft <sup>2</sup>
1100 Corporate Blvd	17-19	85,800 ft <sup>2</sup>	0 ft <sup>2</sup>
1110 Corporate Blvd	20	0 ft <sup>2</sup>	3,013 ft <sup>2</sup>
Corporate Blvd	21,22a	0 ft <sup>2</sup>	0 ft <sup>2</sup>
1150 Corporate Blvd	22b	10,400 ft <sup>2</sup>	0 ft <sup>2</sup>
1180 Corporate Blvd	23	0 ft <sup>2</sup>	0 ft <sup>2</sup>
1200 Corporate Blvd	24	108,202 ft <sup>2</sup>	0 ft <sup>2</sup>
Corporate Blvd	25,26	0 ft <sup>2</sup>	0 ft <sup>2</sup>
1260 Corporate Blvd	27,28	85,250 ft <sup>2</sup>	0 ft <sup>2</sup>
<b>Totals:</b>		<b>666,236 ft<sup>2</sup></b>	<b>3,013 ft<sup>2</sup></b>

Dated: August 1, 2007

\* Lot 9 is Excluded from floor plan calculation

**Calculations:**

Total Non-Accessory Use Gross Floor Area:	663,223
Calculated Gross Floor Area for Accessory Uses 20%:	133,247
Existing Accessory Uses Gross Floor Area:	3,013
Remaining Allowable Gross Floor Area for Future Accessory Uses:	130,234

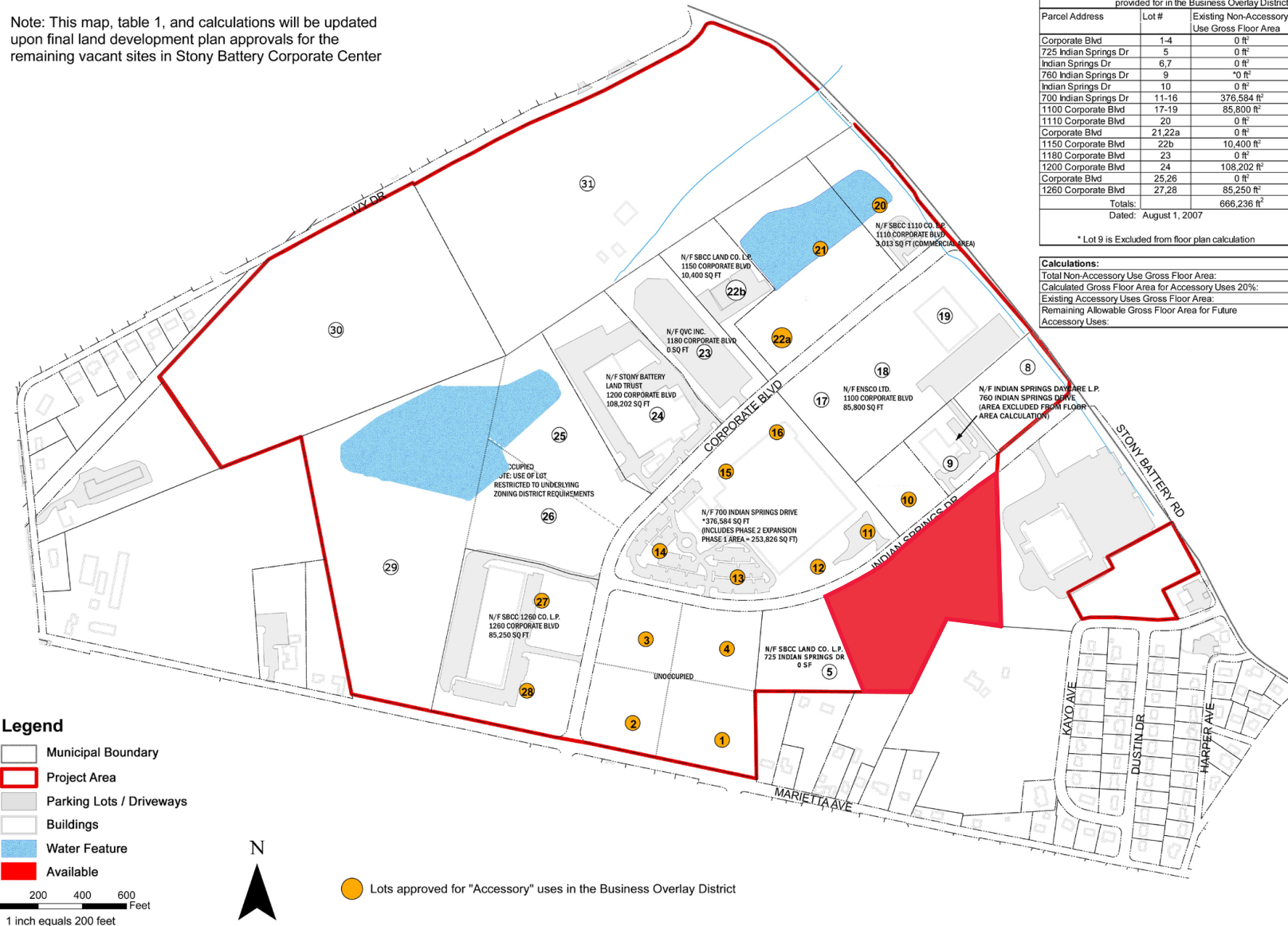

FILE LOCATION: S:\DOCS\07\07-141 Regency V\Graphics\13-02-22 STONY BATTERY MGMT CO LLC BUSINESS OVERLAY MAP



STONY BATTERY  
MANAGEMENT LLC  
1899 LUTITZ PIKE  
LANCASTER, PA 17601

STONY BATTERY  
CORPORATE CENTER  
WEST HEMPFIELD TOWNSHIP, LANCASTER COUNTY, PA

Plan Scale: One inch equals Two Hundred (200) Feet  
Plan Date: May 23, 2007  
Project: Stony Battery Corporate Center  
Data Source: Lancaster County GIS  
Projection: NAD 1983 State Plane: Pennsylvania South  
Job Number: 07-141



Jeff Herr | Jeffrey Herr

For Leasing Information: 717.843.5555 | Learn more online at [www.bennettwilliams.com](http://www.bennettwilliams.com)



COMMERCIAL BROKERAGE. *Redefined.*



Available For Sale

## MARKET AERIAL

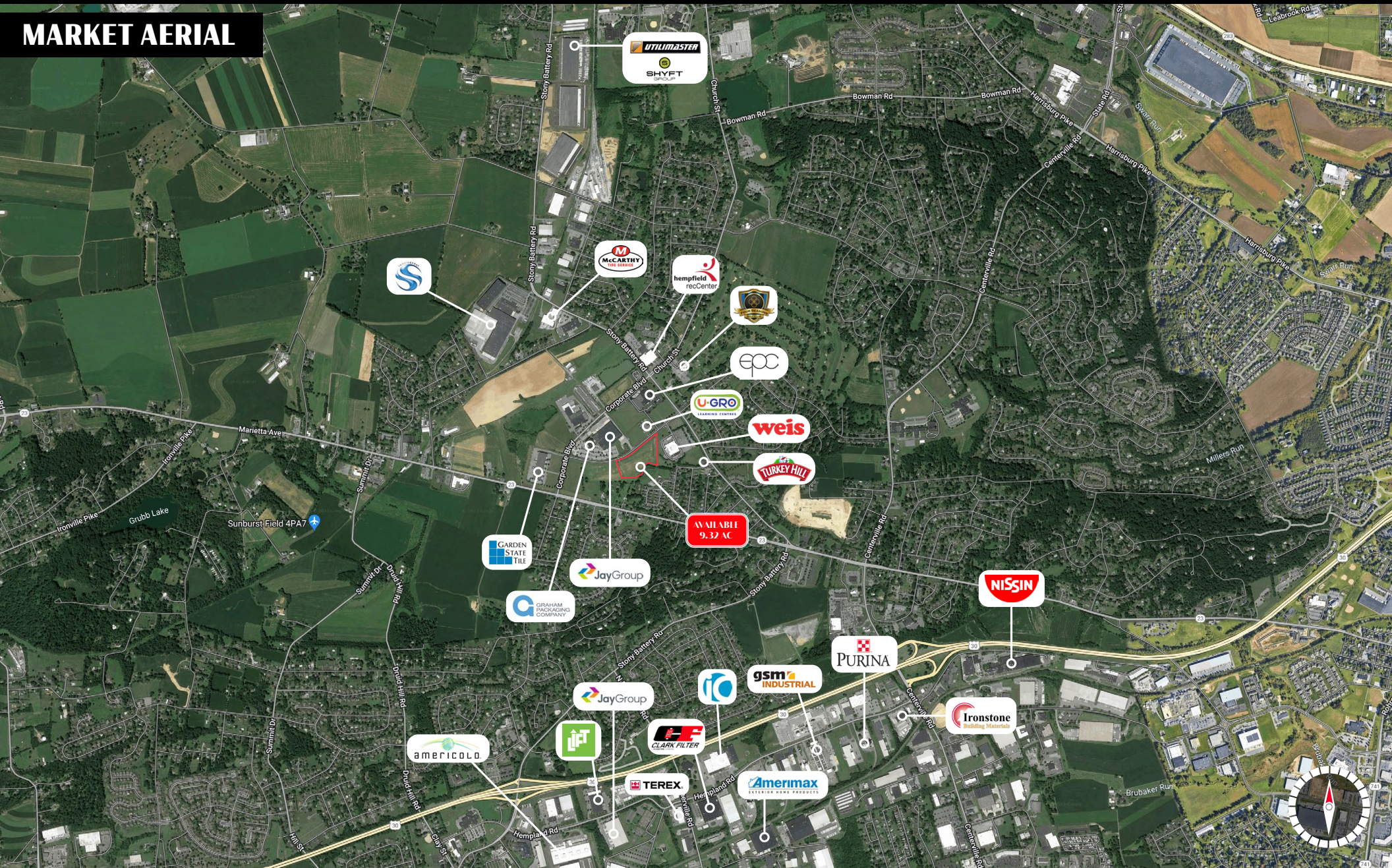

For Leasing Information: 717.843.5555 | Learn more online at [www.bennettwilliams.com](http://www.bennettwilliams.com)

ACTIVE MEMBER OF:  
 **RETAIL** BROKERS  
NETWORK

COMMERCIAL BROKERAGE. *Redefined.*



# Bennett Williams

## COMMERCIAL REAL ESTATE

### OUR LOCATIONS:

#### **YORK OFFICE:**

3528 Concord Rd.  
York, PA 17402

#### **LANCASTER OFFICE:**

150 Farmington Lane, Suite 201  
Lancaster, PA 17601

#### **EXTON OFFICE:**

1 E. Uwchlan Ave.  
Suite 409, Exton, PA 19341

#### **STATE COLLEGE OFFICE:**

330 Innovation Blvd, Suite 205  
State College, PA 16803

#### **WEST CHESTER OFFICE:**

107 E Chestnut St, Suite 1  
West Chester, PA 19380

#### **NEW JERSEY OFFICE:**

236 E. Route 38, Suite 130  
Moorestown, NJ 08057

### LISTING AGENTS:



#### **Jeff Herr**

[jherr@bennettwilliams.com](mailto:jherr@bennettwilliams.com)



#### **Jeffrey Herr**

[jherr2@bennettwilliams.com](mailto:jherr2@bennettwilliams.com)

#### **CONTACT US**

717.843.5555 | [www.bennettwilliams.com](http://www.bennettwilliams.com)

LANDLORD  
REPRESENTATION

TENANT  
REPRESENTATION

INVESTMENT  
SALES

PROPERTY  
MANAGEMENT



## About Bennett Williams

Since its founding in 1956, Bennett Williams Commercial, Inc. has offered full Commercial Real Estate services to the Central Pennsylvania region and beyond. We have served thousands of commercial, industrial and retail clients as we have grown in size and reputation. With our team of both experienced and knowledgeable executives as well as young and energetic professionals, we have the team to handle any commercial real estate need.

Bennett Williams is a member of the Retail Brokers Network (RBN), a partnership of the best regional retail brokerage firms servicing all of the major markets across the United States. Our affiliates are handpicked ensuring that our clients receive top quality service and representation in any market they need help in, with 61 offices across 65+ markets and 700+ members.

