

# FOR LEASE

12,848 SF  
Storefront Retail Space

Building & Pylon  
Signage Available

# PEPBOYS AUTO



1050 E. Hunting Park Ave  
Philadelphia, PA 19124

VESTIAN

Bennett WILLIAMS  
COMMERCIAL REAL ESTATE

# 1050 E. Hunting Park Ave

## Property Overview

Pep Boys holds these properties under long term ground leases. The tire and auto repair operations will continue, the former parts sales areas have already been vacated, sizes fall in the range of 3,200 to 11,500 SF.

Uses sought include medical, such as dialysis or Plasma centers, day care for children, doggie day care, discount retail, furniture, tools, hardware and automotive uses that don't compete with the tire and repair operations, such as collision centers, auto glass or auto parts.

Cash allowances can be negotiated, provided the rent is commensurate with a reasonable return on the additional investment.

- Highly visible from all directions
- Ample parking
- Typically located among nationally recognized retailers
- Size of space can be flexible

## Nearby Retailers



### CONTACT

**Don Gill**

847.630.1070 | [gill@vestian.com](mailto:gill@vestian.com)

**Patrick Kobilca**

708.431.8894 | [kobilca@vestian.com](mailto:kobilca@vestian.com)

**Jane McGill**

610.517.4380 | [jmcgill@bennettwilliams.com](mailto:jmcgill@bennettwilliams.com)

**Anthony Curcio**

484.571.5764 | [acurcio@bennettwilliams.com](mailto:acurcio@bennettwilliams.com)

# 1050 E. Hunting Park Ave

## PROPERTY OVERVIEW

|                   |   |
|-------------------|---|
| Address           | 1050 E. Hunting Park Ave<br>Philadelphia, PA 19124  |
| Available SF      | 12,848 SF   |
| Occupied SF       | 7,022 SF  |
| Total Building SF | 19,870 SF (PB Space)<br>28,411 (Retail Plaza)   |
| Year Built        | 1980  |
| Possession        | Immediate   |
| Signage           | Building & Pylon Signage Available  |
| Asking Rate       | Contact Broker  |
| Comments          | <ul style="list-style-type: none"><li>• Dedicated Main Entrance</li><li>• Building Height 20'</li><li>• Sprinklered</li><li>• HVAC throughout</li><li>• Gas Service</li><li>• Municipal Water/Sewer</li></ul> |

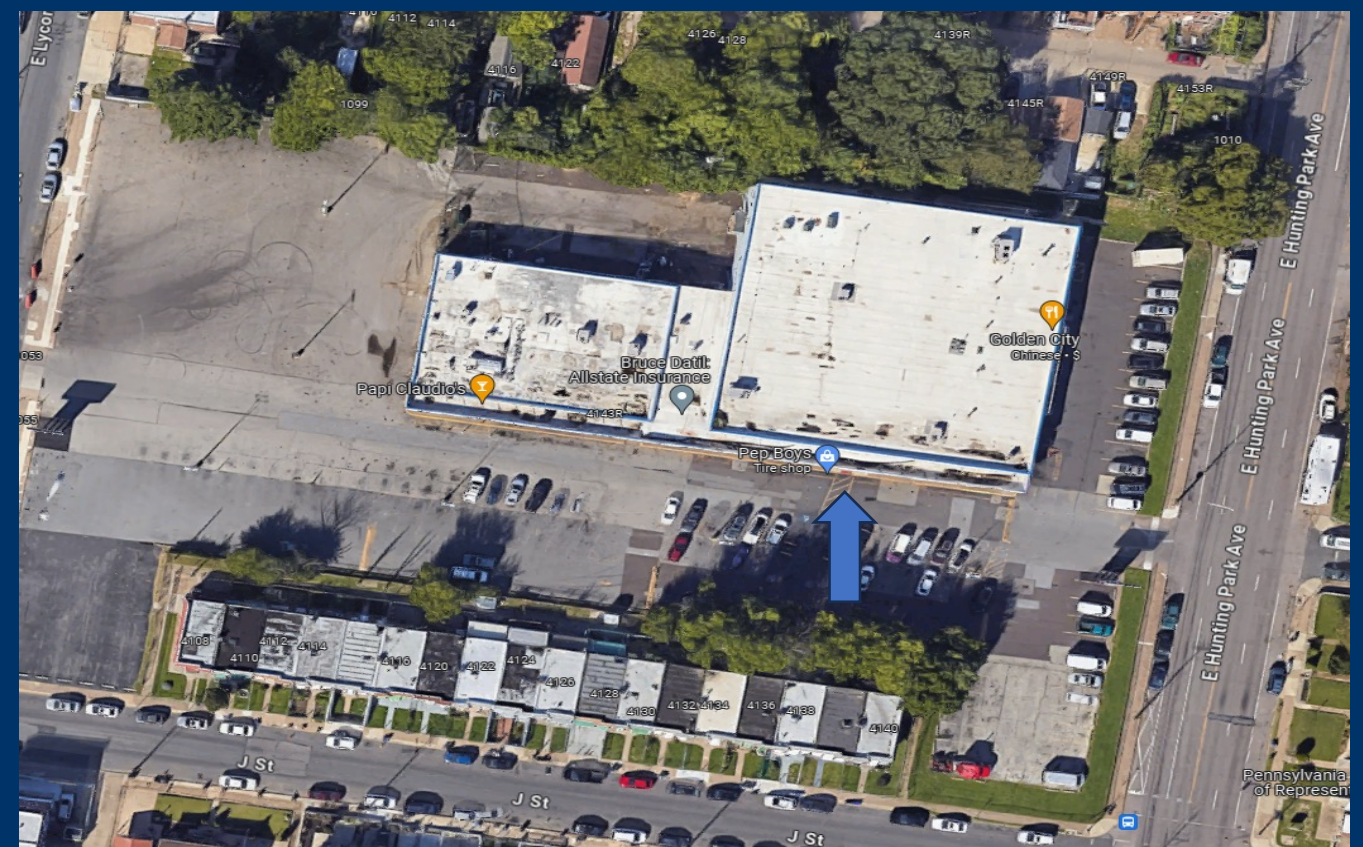

### CONTACT

**Don Gill**  
**Patrick Kobilca**

847.630.1070 | [gill@vestian.com](mailto:gill@vestian.com)  
708.431.8894 | [kobilca@vestian.com](mailto:kobilca@vestian.com)

**Jane McGill**  
**Anthony Curcio**

610.517.4380 | [jmcgill@bennettwilliams.com](mailto:jmcgill@bennettwilliams.com)  
484.571.5764 | [acurcio@bennettwilliams.com](mailto:acurcio@bennettwilliams.com)

# 1050 E. Hunting Park Ave

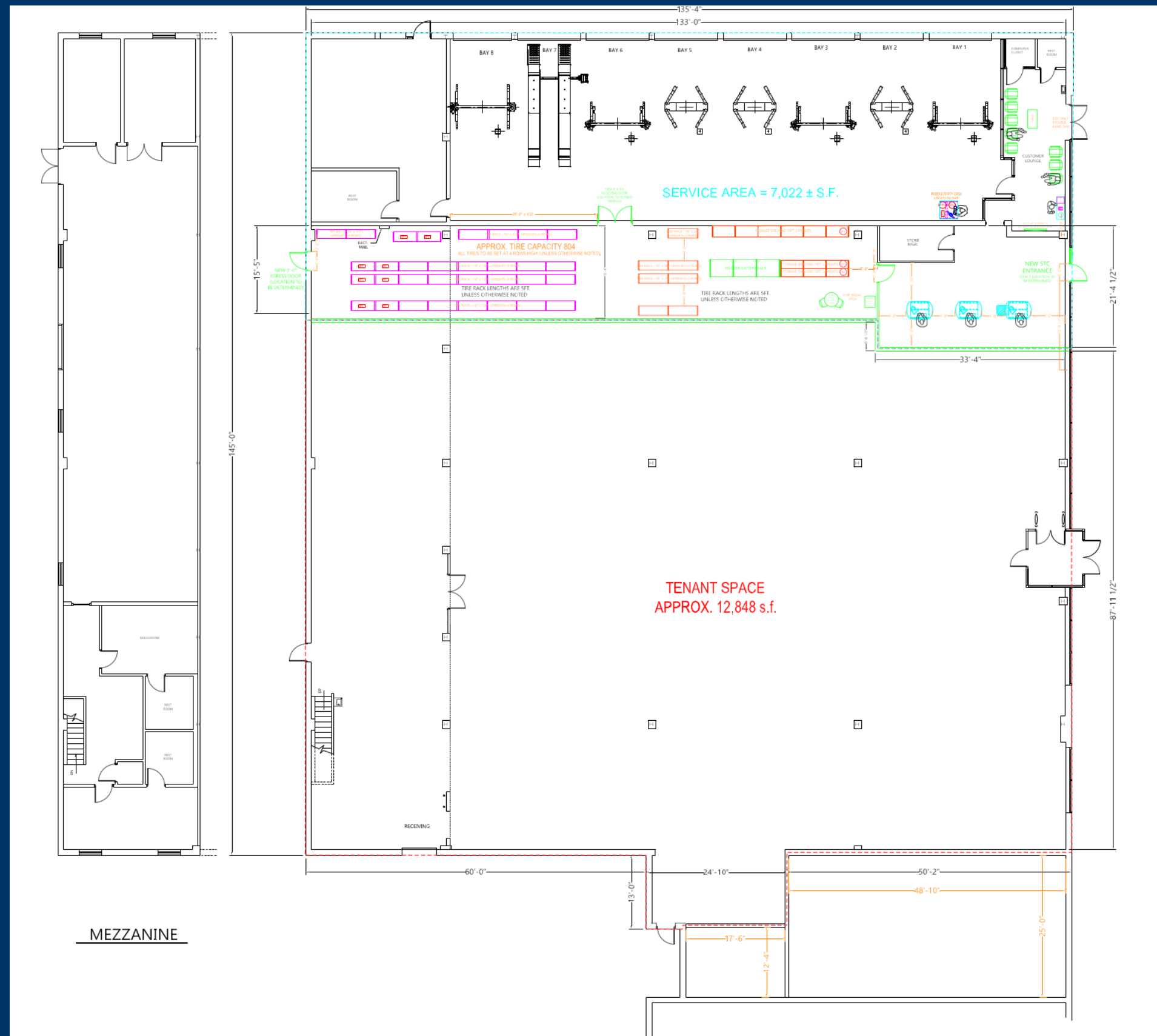

**CONTACT**

**Don Gill**  
**Patrick Kobilca**

847.630.1070 | [gill@vestian.com](mailto:gill@vestian.com)  
708.431.8894 | [kobilca@vestian.com](mailto:kobilca@vestian.com)

**Jane McGill**  
**Anthony Curcio**

610.517.4380 | [jmcgill@bennettwilliams.com](mailto:jmcgill@bennettwilliams.com)  
484.571.5764 | [acurcio@bennettwilliams.com](mailto:acurcio@bennettwilliams.com)

# 1050 E. Hunting Park Ave

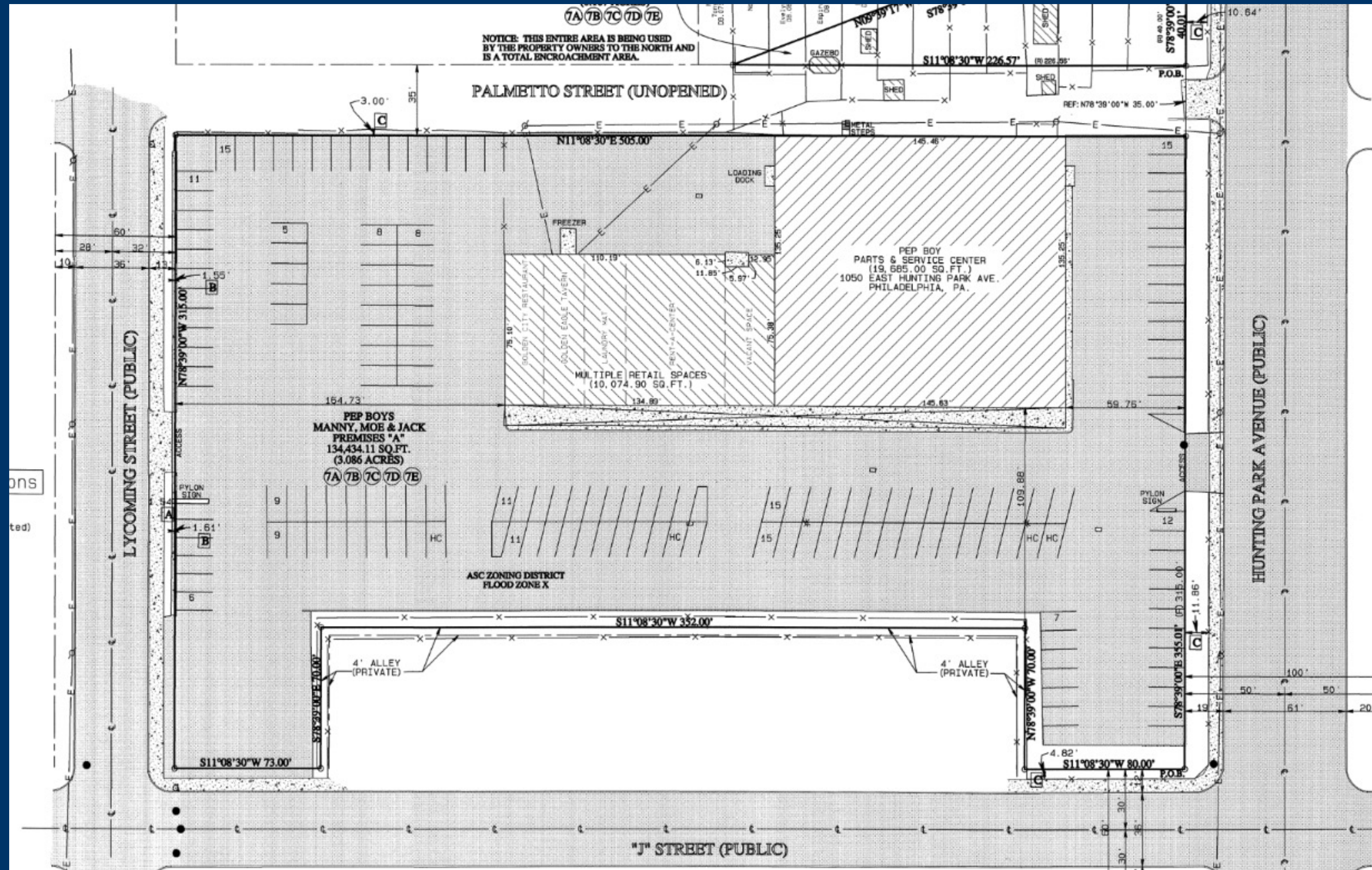

## CONTACT

**Don Gill**  
**Patrick Kobilca**

847.630.1070 | [gill@vestian.com](mailto:gill@vestian.com)  
708.431.8894 | [kobilca@vestian.com](mailto:kobilca@vestian.com)

**Jane McGill**  
**Anthony Curcio**

610.517.4380 | [jmcgill@bennettwilliams.com](mailto:jmcgill@bennettwilliams.com)  
484.571.5764 | [acurcio@bennettwilliams.com](mailto:acurcio@bennettwilliams.com)

# Building & Pylon Signage Renderings



*\*Signage renderings provided for illustrative purposes only.  
Actual design and placement may vary based on location and specific property requirements.*

## CONTACT

**Don Gill**  
**Patrick Kobilca**

847.630.1070 | [gill@vestian.com](mailto:gill@vestian.com)  
708.431.8894 | [kobilca@vestian.com](mailto:kobilca@vestian.com)

**Jane McGill**  
**Anthony Curcio**

610.517.4380 | [jmcgill@bennettwilliams.com](mailto:jmcgill@bennettwilliams.com)  
484.571.5764 | [acurcio@bennettwilliams.com](mailto:acurcio@bennettwilliams.com)



**FOR LEASING INFORMATION,  
CONTACT**

**V E S T I A N**

**Bennett WILLIAMS**  
COMMERCIAL REAL ESTATE

**Don Gill**

847.630.1070

[gill@vestian.com](mailto:gill@vestian.com)

**Patrick Kobilca**

708.431.8894

[kobilca@vestian.com](mailto:kobilca@vestian.com)

**Jane McGill**

610.517.4380

[jmcgill@bennettwilliams.com](mailto:jmcgill@bennettwilliams.com)

**Anthony Curcio**

484.571.5764

[acurcio@bennettwilliams.com](mailto:acurcio@bennettwilliams.com)

©2024 Vestian. All rights reserved. The information contained within this report is gathered from multiple sources believed to be reliable but has not been verified for accuracy or completeness. You should conduct a careful, independent investigation of the property and verify all information. Any reliance on this information is solely at your own risk. Photos herein are the property of their respective owners. Use of these images without the express written consent of the owner is prohibited.

Vestian and the Vestian logo are service marks of Vestian Global Workplace Services, LLC. All other marks displayed on this document are the property of their respective owners.